



# DESIGNING WITH RUBY

by **Alexander C. Schreyer**

Lecturer,  
University of Massachusetts, Amherst

2012 SketchUp Basecamp, Boulder, CO



# WHAT WE'RE GOING TO DO...

- ▶ How can we use Ruby for Design?
- ▶ Editing code in SketchUp
- ▶ What can Ruby do for us?
- ▶ A simple example: colorful boxes
- ▶ Use some math to design a panel
- ▶ Responsive designs, dynamic components
- ▶ Want to learn more?

IMPORTANT: I use “pragmatic programming”  
to keep things simple

HOW CAN WE USE RUBY FOR  
DESIGN?



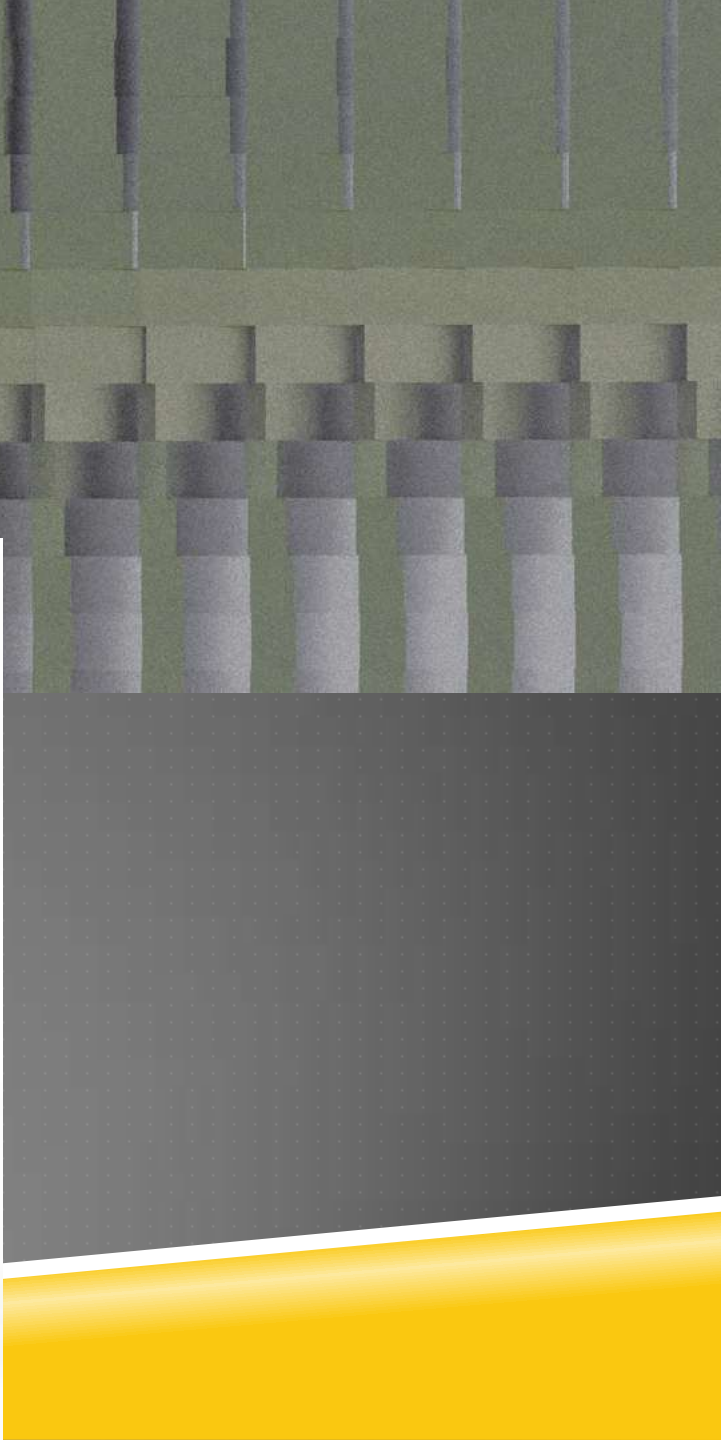
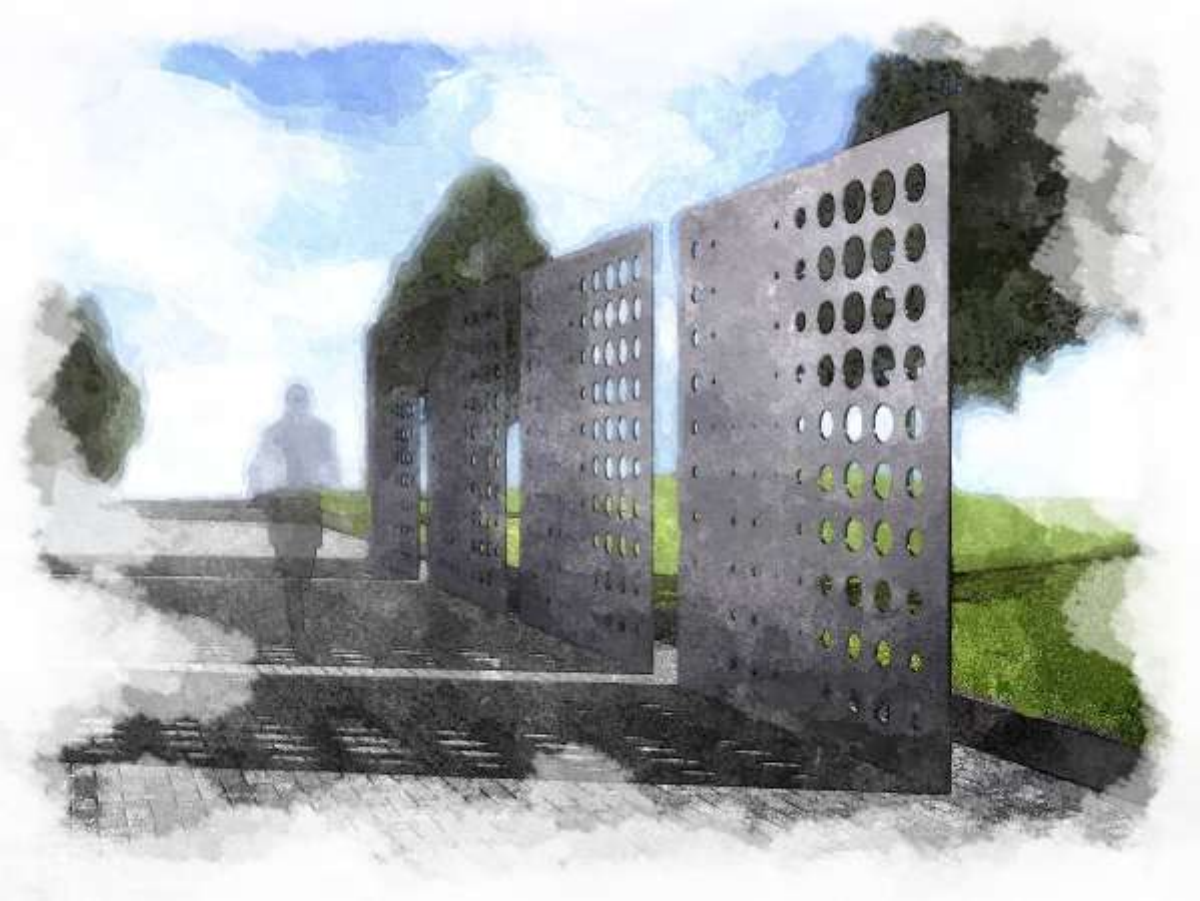
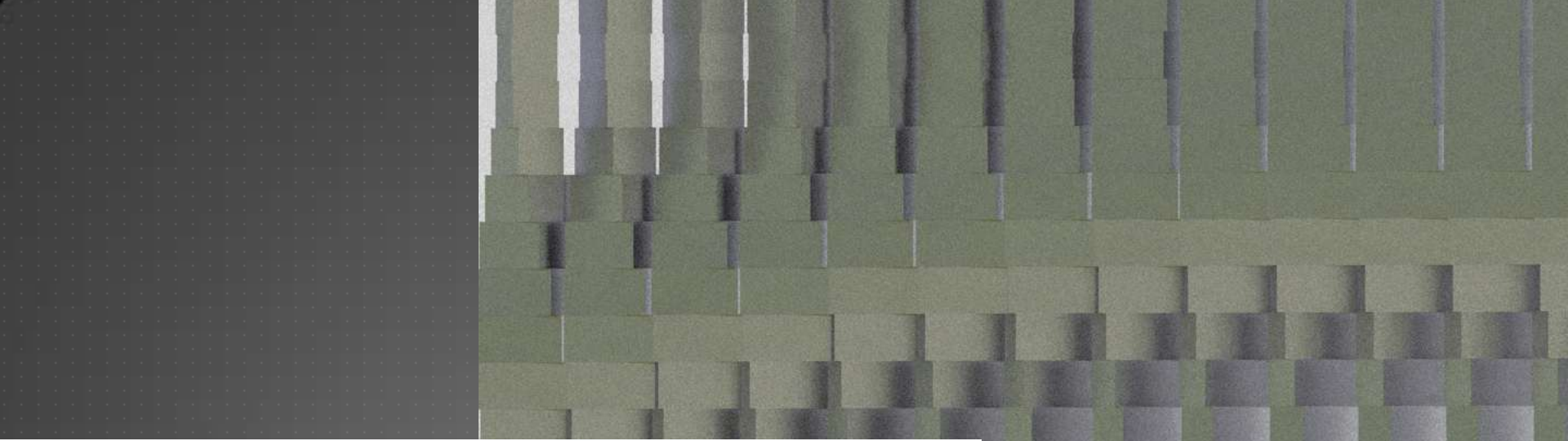

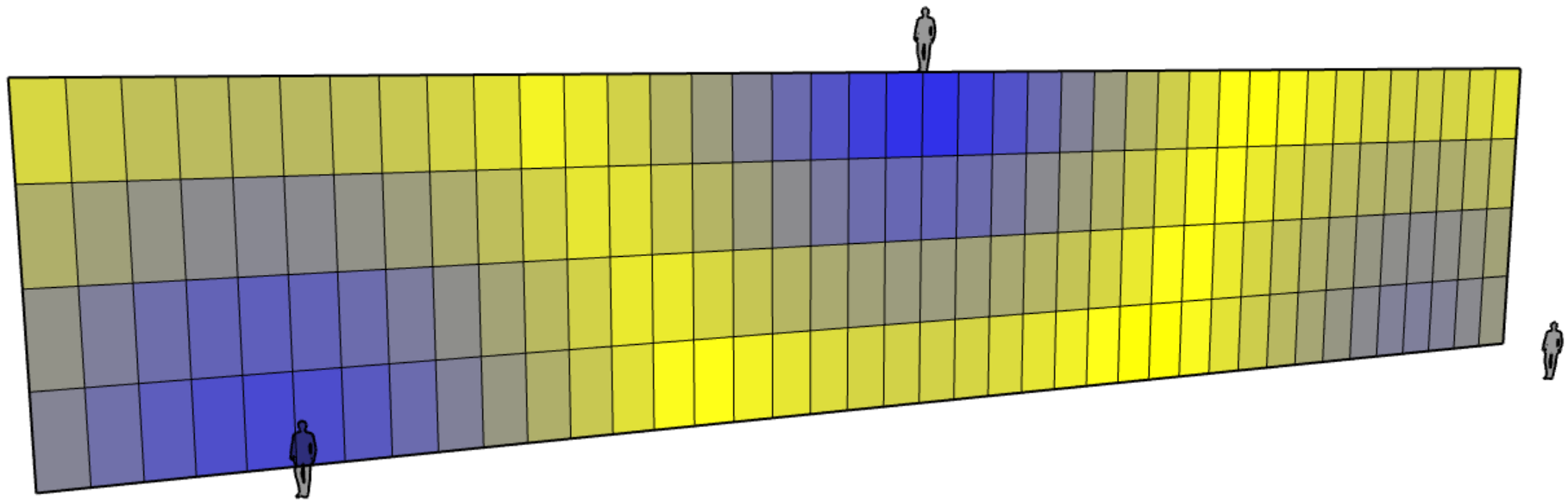
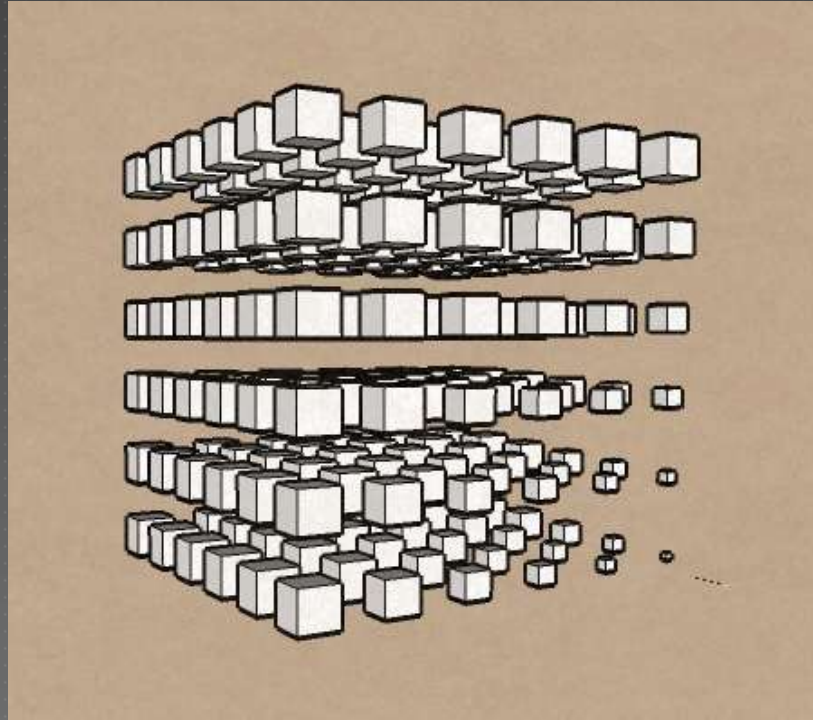

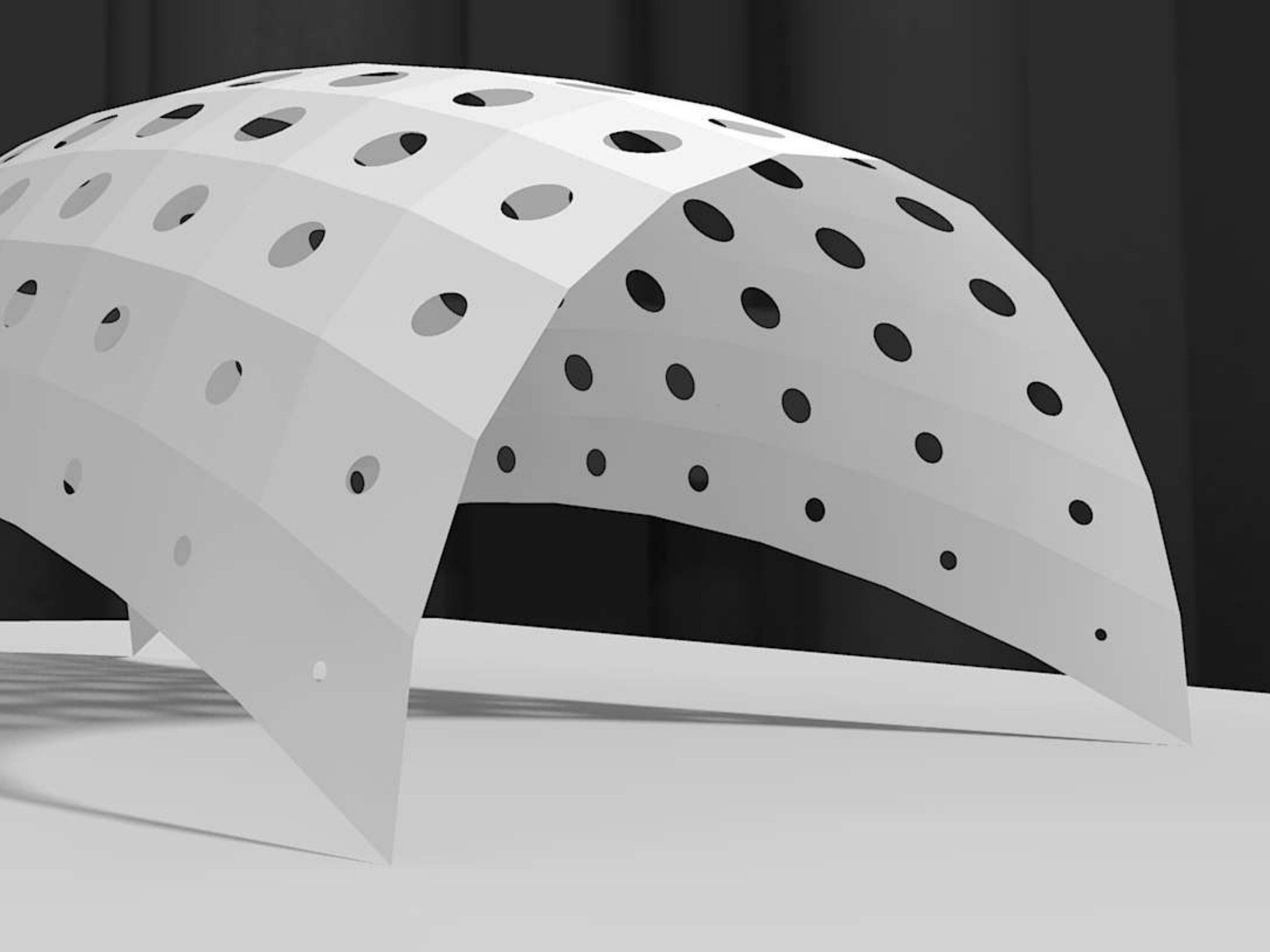

# EDITING CODE IN SKETCHUP



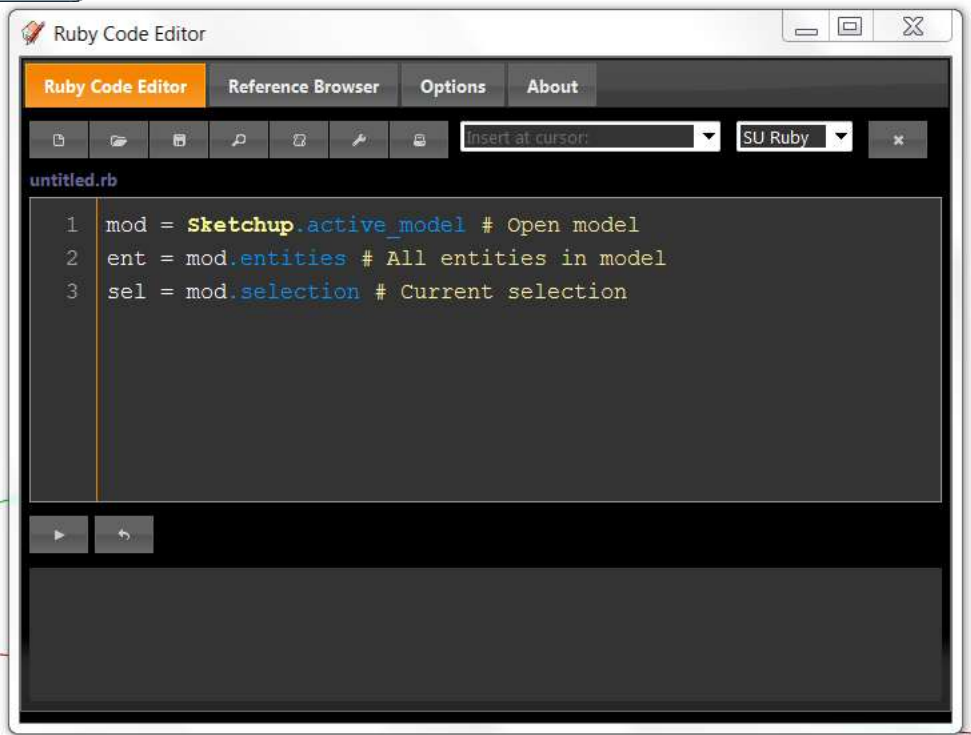
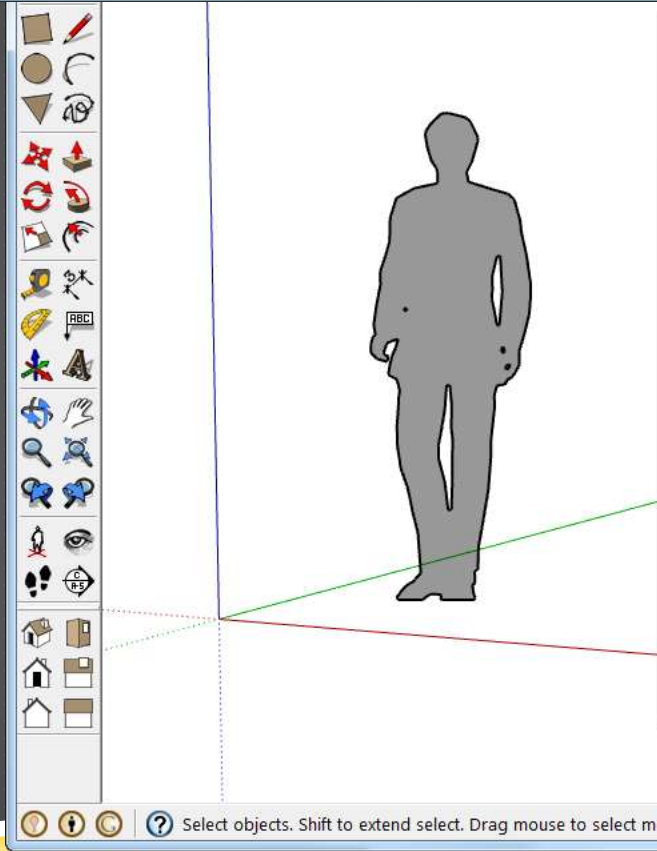
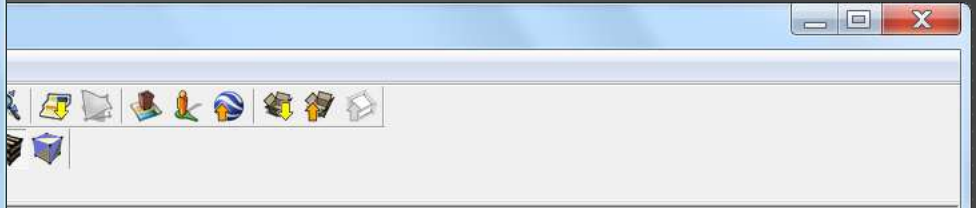
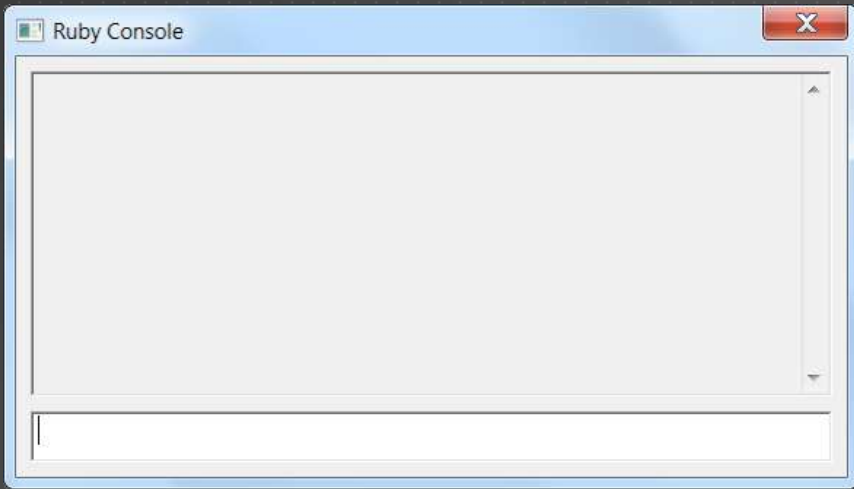



WHAT CAN RUBY DO FOR US?



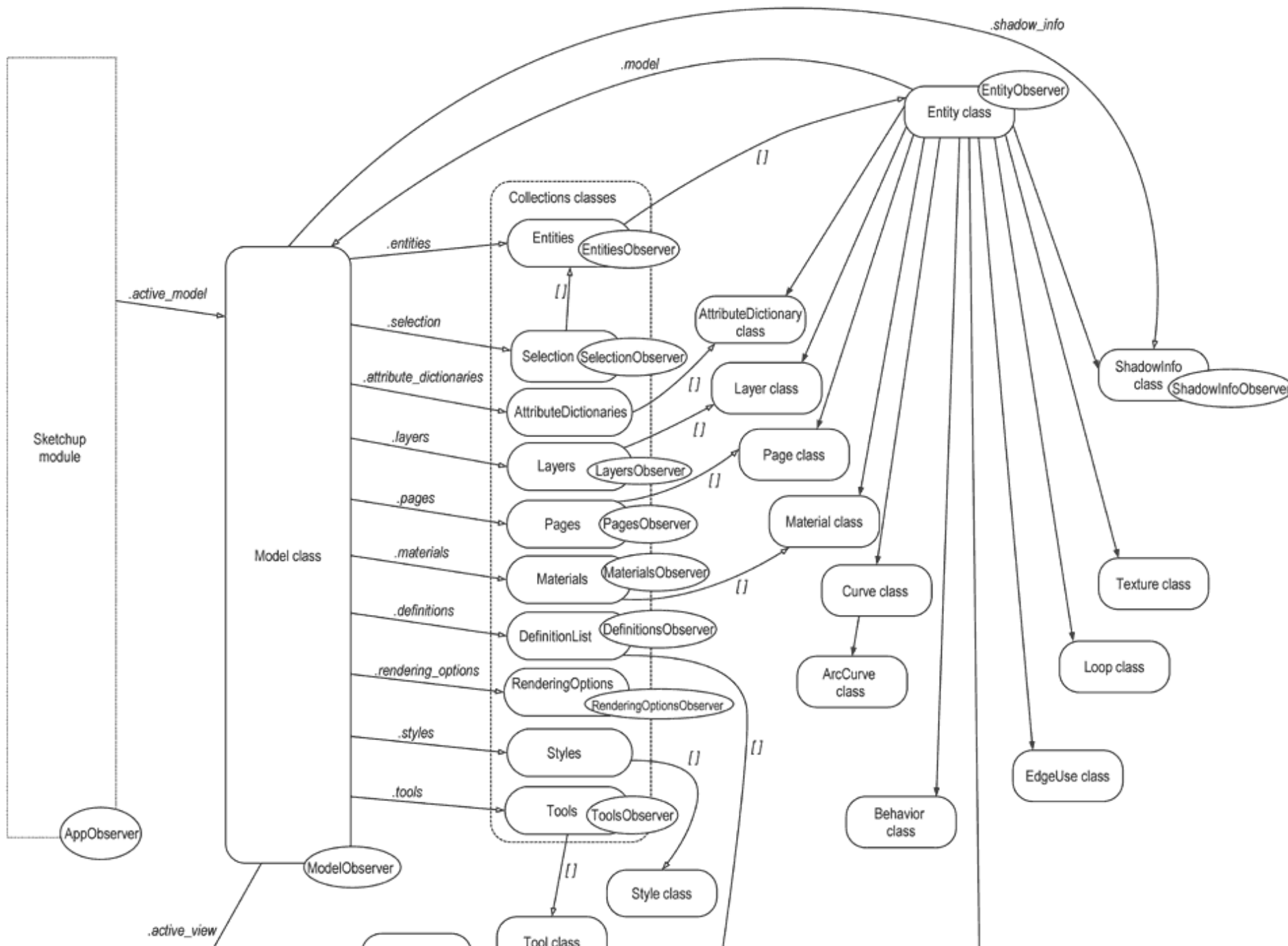

# RELEVANT FUNCTIONALITY

## ▶ Creating objects

- ▶ `Sketchup.active_model.entities`
- ▶ Lines, circles, polygons, meshes, components, construction points

## ▶ Manipulating objects

## ▶ Importing data

## ▶ Connect to the web with a WebDialog

## Entities (Parent: Object)

```
.[] .add_3d_text .add_arc  
.add_circle  
.add_cline .add_cpoint .add_curve  
.add_edges .add_face  
.add_faces_from_mesh .add_group  
.add_image .add_instance .add_line  
.add_ngon .add_observer .add_text  
.at .clear! .count .each  
.erase_entities  
.fill_from_mesh .intersect_with  
.length  
.model .parent .remove_observer  
.transform_by_vectors  
.transform_entities
```

# EXAMPLE: MAKE COLORFUL BOXES

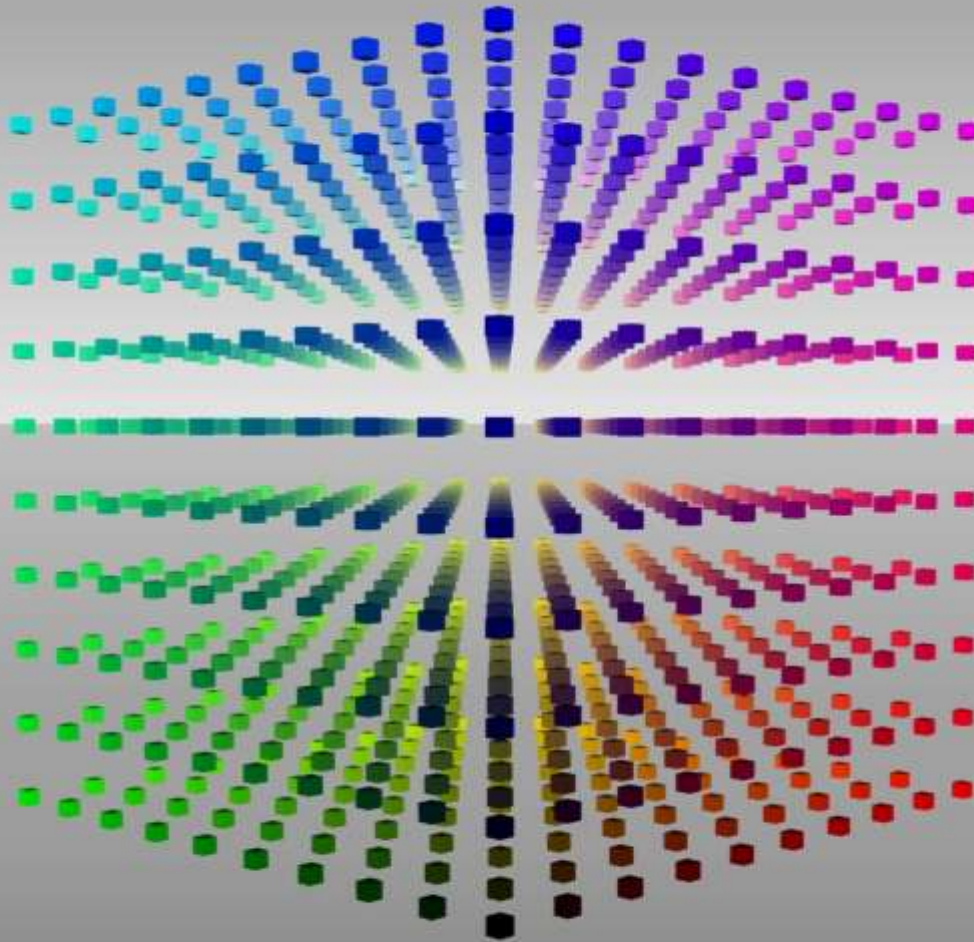

```
ent = Sketchup.active_model.entities
```

```
n = 5      # number of boxes
```

```
s = 100    # spacing
```

```
w = 50     # box width
```

```
(0..n-1).each { |i|
```

```
  (0..n-1).each { |j|
```

```
    (0..n-1).each { |k|
```

```
      face = ent.add_face
```

```
        [i*s,j*s,k*s],[i*s,j*s+w,k*s],[i*s+w,j*s+w,k*s],[i*s+w,j*s,k*s]
```

```
      face.back_material = [(255/n*i).round,(255/n*j).round,(255/n*k).round]
```

```
      face.pushpull -w
```

```
    }
```

```
  }
```

```
}
```

# EXAMPLE: USE SINES FOR PANELS

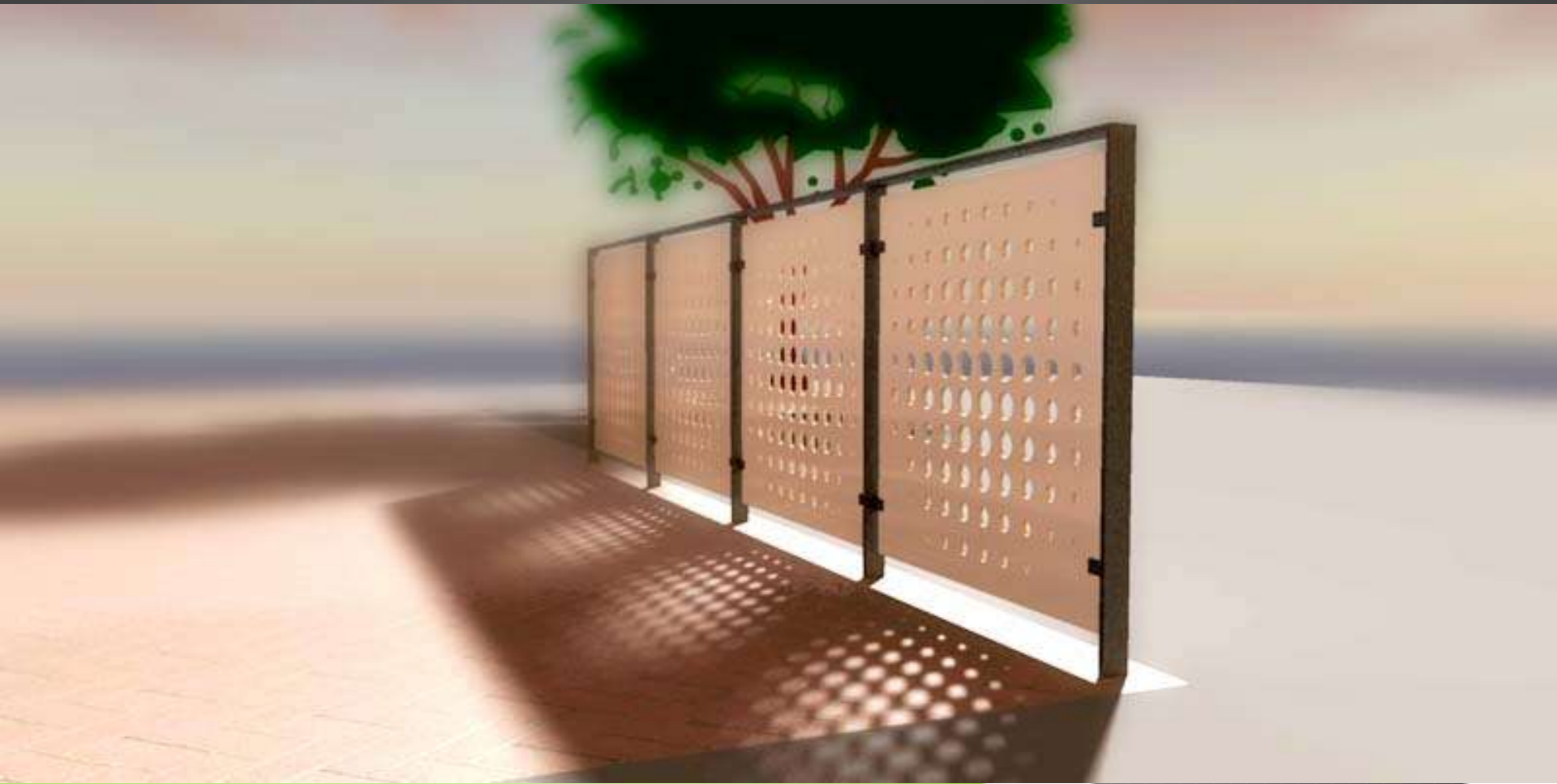

```
ent = Sketchup.active_model.entities
```

```
w = 36          # width of square
```

```
n = 10         # number of circles
```

```
s = w/(n+1).to_f # spacing
```

```
ent.add_face [0,0,0],[w,0,0],[w,w,0],[0,w,0]
```

```
(0..n-1).each { |i|
```

```
  (0..n-1).each { |j|
```

```
    ent.add_circle [s+i*s,s+j*s,0], [0,0,1],  
      sin(i/(n-1).to_f*1*PI)*s/5.0+sin(j/(n-1).to_f*1*PI)*s/5.0
```

```
  }
```

```
}
```

# RESPONSIVE DESIGN

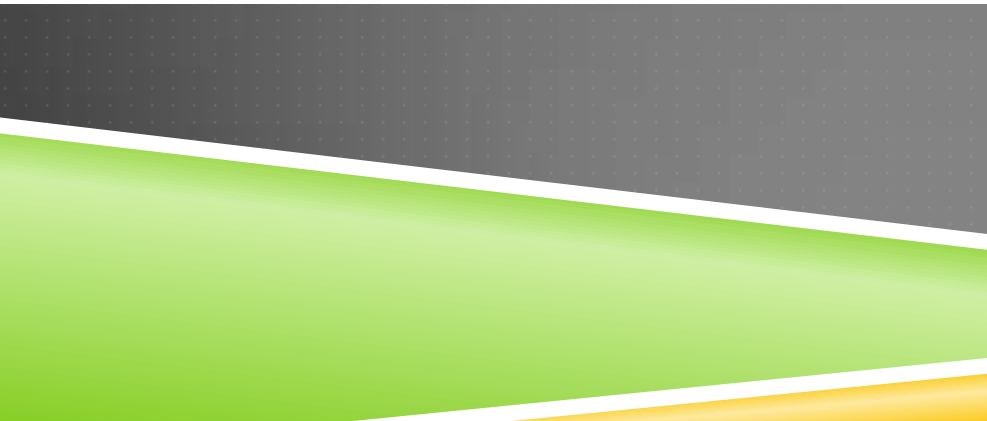
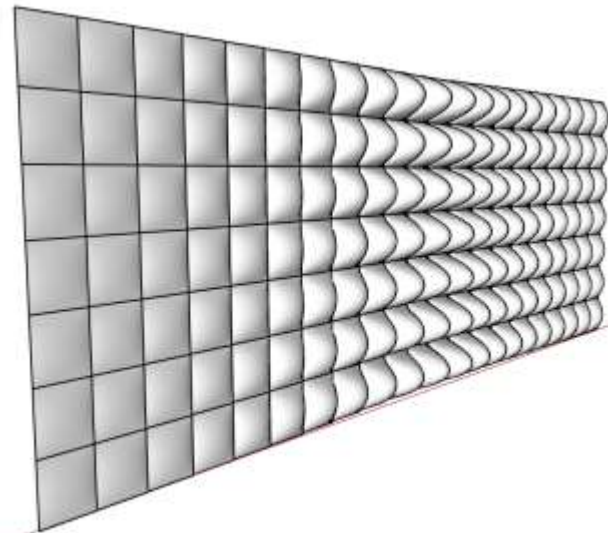
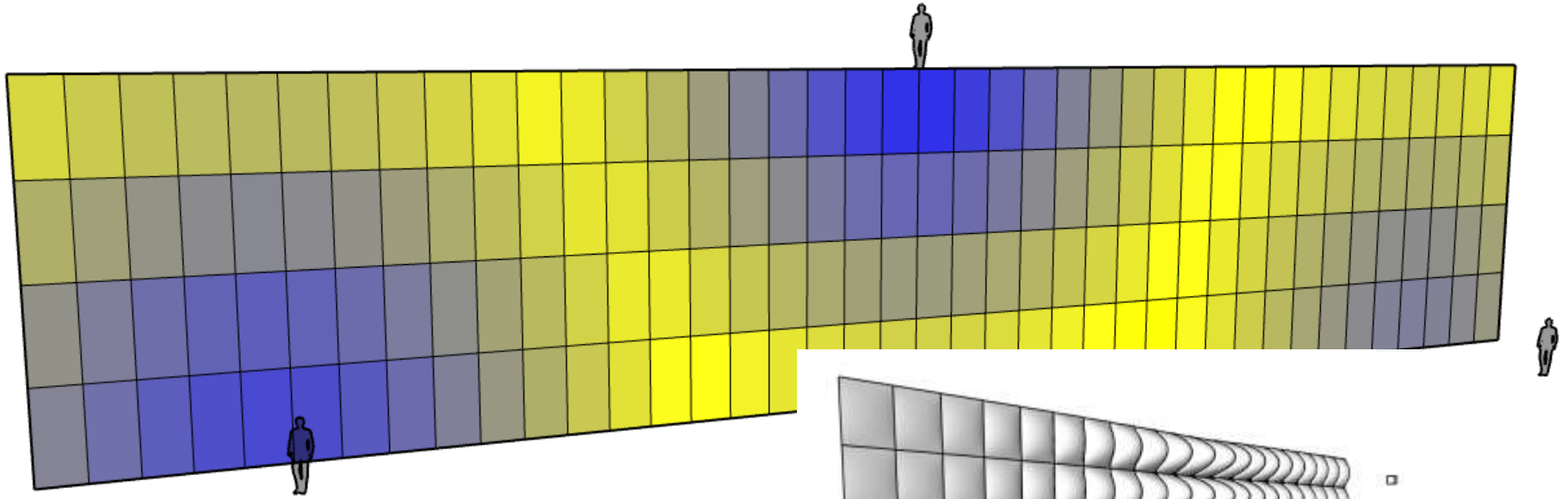



# SCRIPTING DYNAMIC COMPONENTS

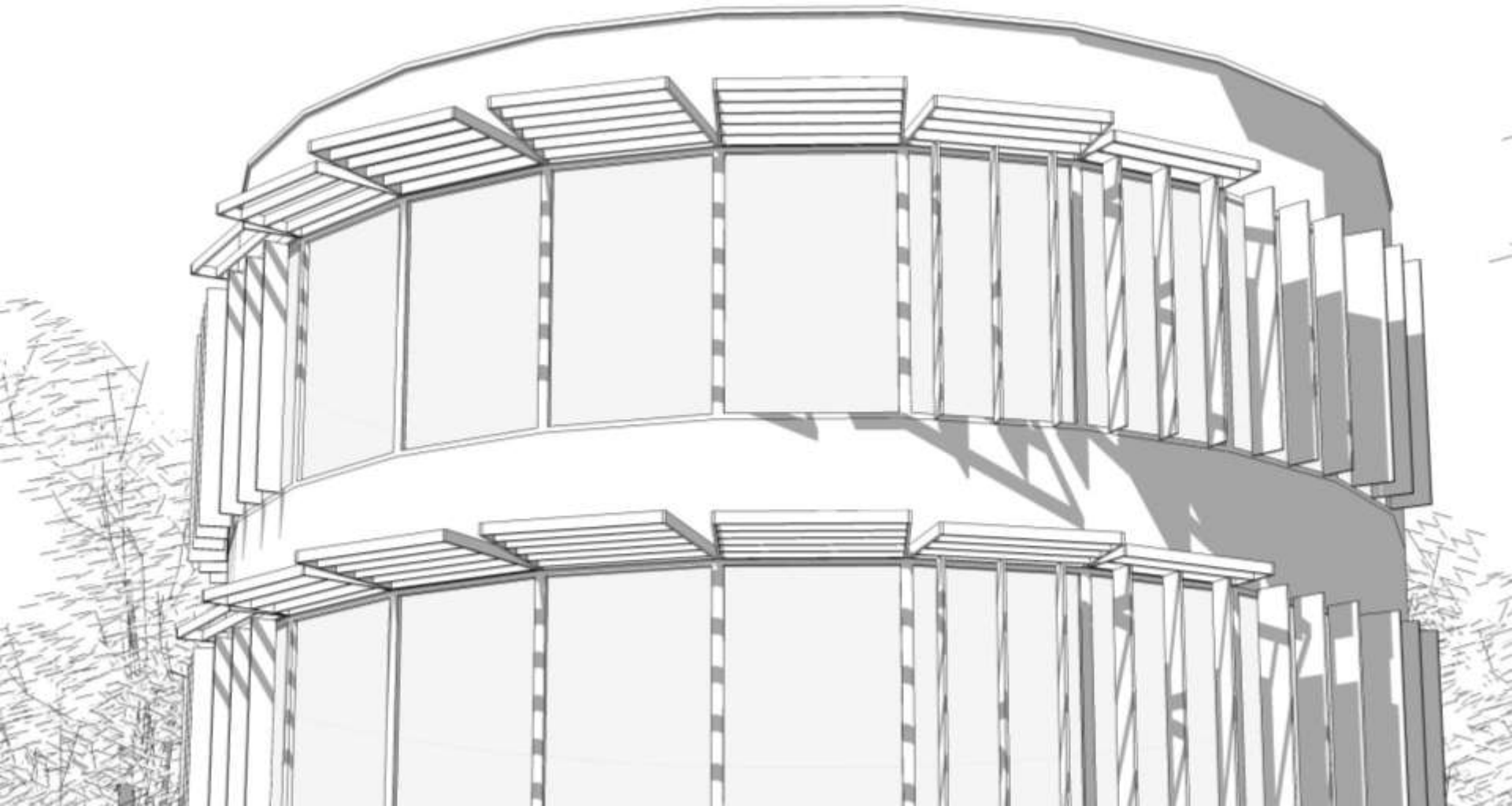

# PLACING COMPONENTS

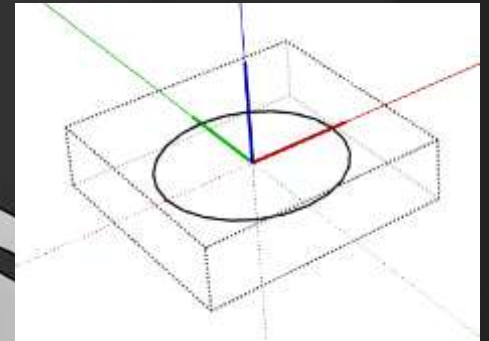
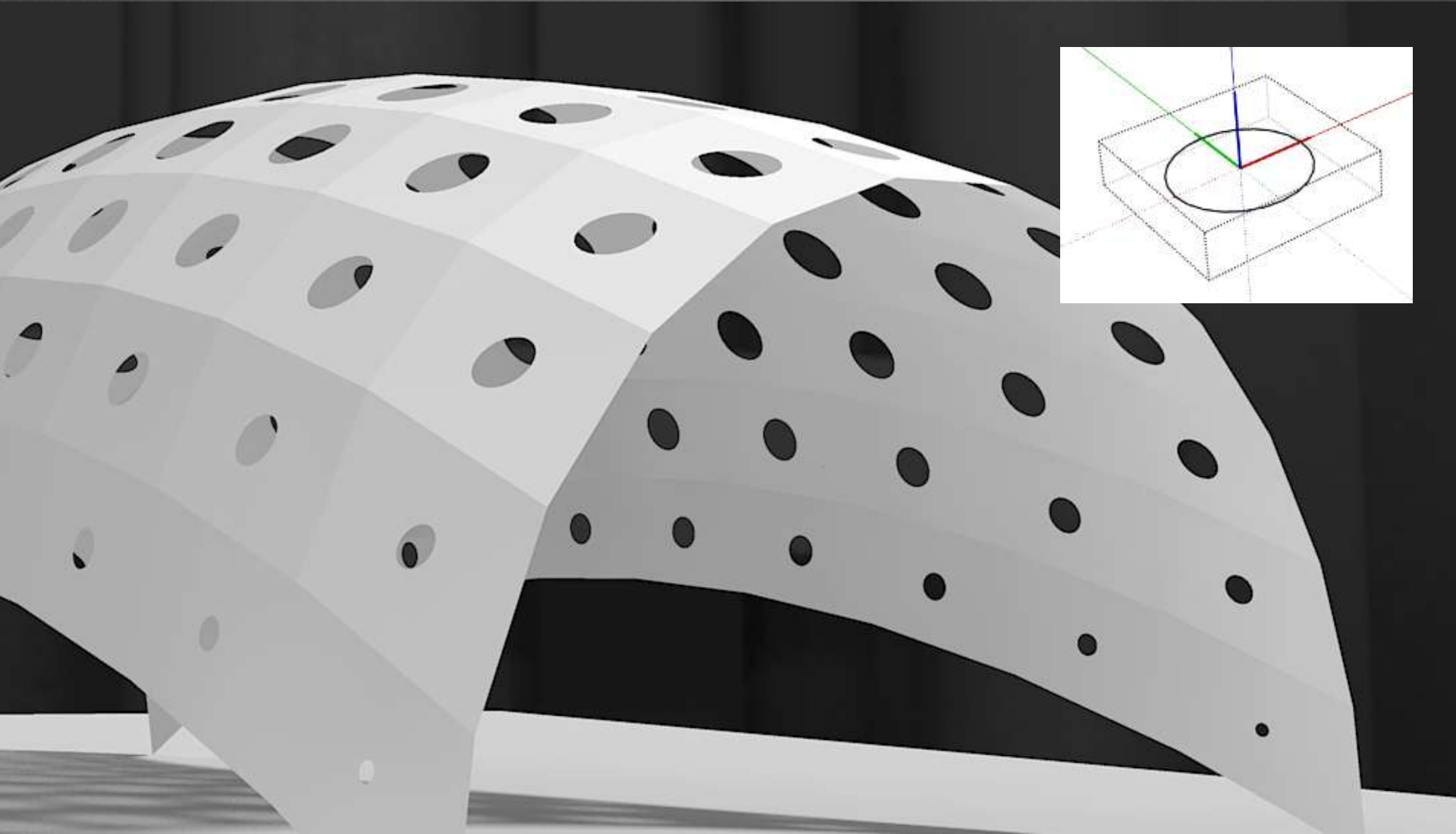

# WANT TO KNOW MORE?

- ▶ Get my book (Nov. 14<sup>th</sup>):  
[www.goo.gl/UjiRa](http://www.goo.gl/UjiRa)
- ▶ Companion website:  
[www.sketchupfordesign.com](http://www.sketchupfordesign.com)
- ▶ Get the editor plugin:  
[www.sketchupplugins.com](http://www.sketchupplugins.com)
- ▶ More about me:  
[www.alexschreyer.net](http://www.alexschreyer.net)
- ▶ Twitter, FB, Google+, ...

